



## **Light Switch H2 US – User Manual**

For

Light Switch H2 US (2 Buttons, 1 Channel)

Light Switch H2 US (2 Buttons, 2 Channels)

Light Switch H2 US (4 Buttons, 3 Channels)

## Product Introduction

Aqara Light Switch H2 US is a smart switch based on Thread/Zigbee wireless communication protocols which can control lights, automations, and scenes. When used with a hub, it can be controlled via the app, and has features for scheduling, power monitoring, power statistics, and other functions. It can also be used with other smart devices to enable a variety of interconnected control functions.

\*This product needs to be used with a device that has Matter Border Router function.

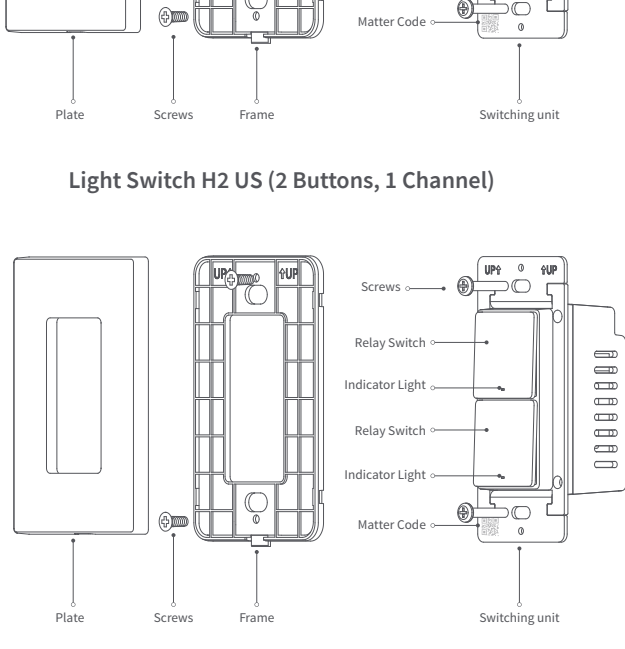

### Light Switch H2 US (2 Buttons, 1 Channel)

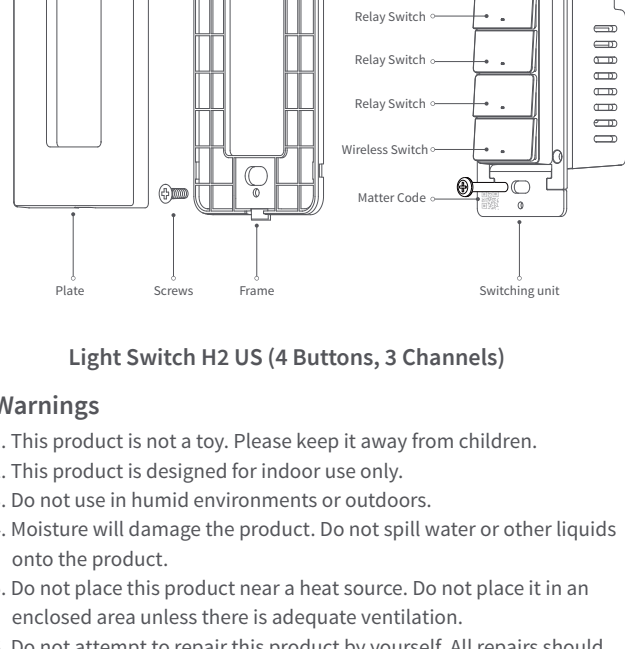

### Light Switch H2 US (2 Buttons, 2 Channels)

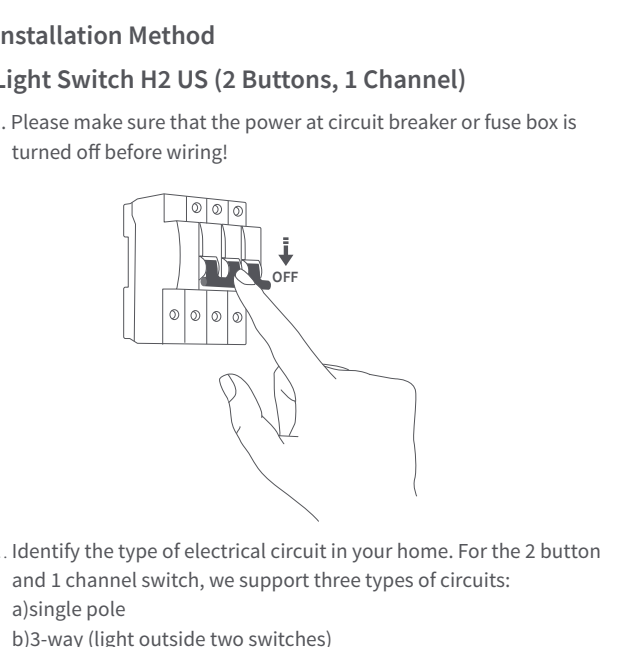

### Light Switch H2 US (4 Buttons, 3 Channels)

## Warnings

1. This product is not a toy. Please keep it away from children.
2. This product is designed for indoor use only.
3. Do not use in humid environments or outdoors.
4. Moisture will damage the product. Do not spill water or other liquids onto the product.
5. Do not place this product near a heat source. Do not place it in an enclosed area unless there is adequate ventilation.
6. Do not attempt to repair this product by yourself. All repairs should be performed by an authorized professional.
7. This product is suitable for home monitoring and smart home integration. The manufacturer is not responsible for any risks or property losses caused by misuse or failure to follow the product instructions.

## Installation Method

### Light Switch H2 US (2 Buttons, 1 Channel)

1. Please make sure that the power at circuit breaker or fuse box is turned off before wiring!

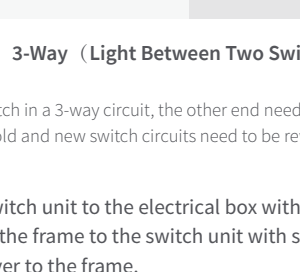

2. Identify the type of electrical circuit in your home. For the 2 button and 1 channel switch, we support three types of circuits:

- a) single pole
- b) 3-way (light outside two switches)
- c) 3-way (light between two switches)

Please follow the instructions below to determine your home's circuit type and wire it correctly. For 3-way circuit wiring, we recommend seeking assistance from a professional electrician.

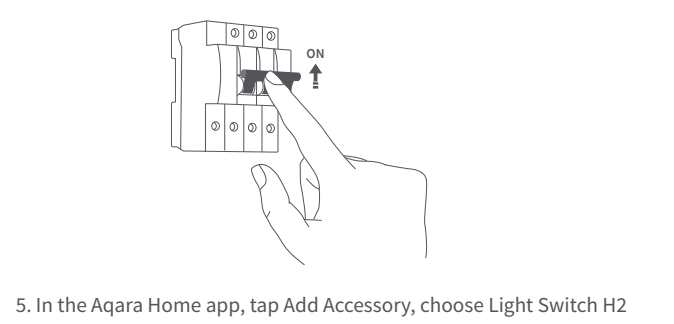

#### Single Pole Wiring

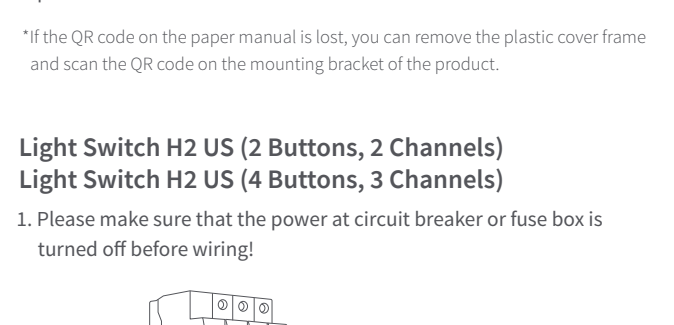

#### 3-Way (Light Outside Two Switches)

\* Use only one switch in a 3-way circuit, the other end needs to be a normal standard switch. Both the old and new switch circuits need to be rewired according to the diagram.

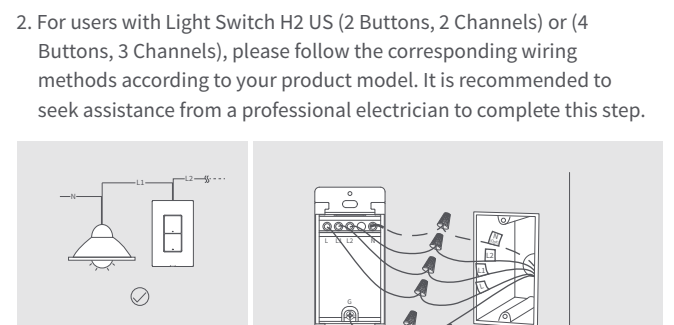

#### 3-Way (Light Between Two Switches)

\* Use only one switch in a 3-way circuit, the other end needs to be a normal standard switch. Both the old and new switch circuits need to be rewired according to the diagram.

3. Mount the switch unit to the electrical box with the attached screws. Then mount the frame to the switch unit with screws, and attach the faceplate cover to the frame.

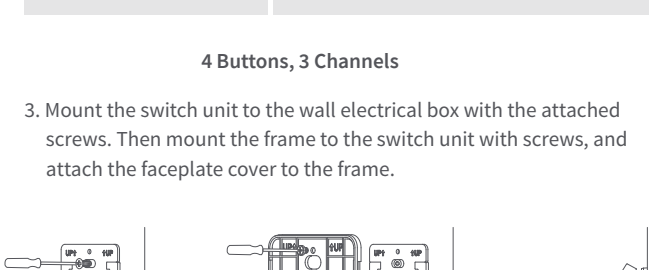

4. Turn on the power at the circuit breaker and test the switch by pressing the upper button. If the wired light can be controlled by the upper button, the switch is functioning correctly.

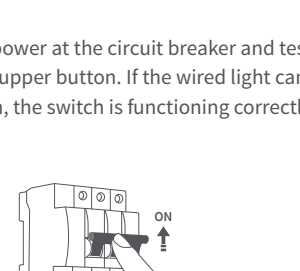

5. In the Aqara Home app, tap Add Accessory, choose Light Switch H2 US. Scan the Matter QR Code on the paper manual to add the device to the app. The following Quick Setup section will introduce the network configuration methods for both Zigbee and Thread protocols.

\* If the QR code on the paper manual is lost, you can remove the plastic cover frame and scan the QR code on the mounting bracket of the product.

### Light Switch H2 US (2 Buttons, 2 Channels)

### Light Switch H2 US (4 Buttons, 3 Channels)

1. Please make sure that the power at circuit breaker or fuse box is turned off before wiring!

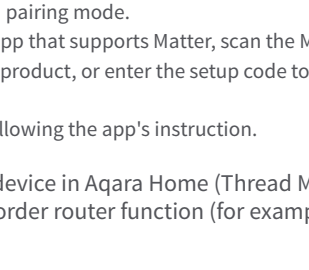

2. For users with Light Switch H2 US (2 Buttons, 2 Channels) or (4 Buttons, 3 Channels), please follow the corresponding wiring methods according to your product model. It is recommended to seek assistance from a professional electrician to complete this step.

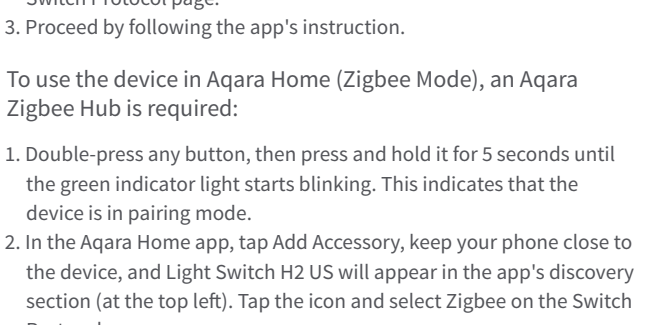

#### 2 Buttons, 2 Channels

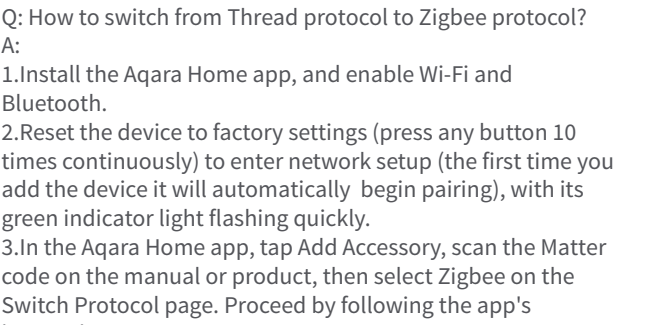

#### 4 Buttons, 3 Channels

3. Mount the switch unit to the wall electrical box with the attached screws. Then mount the frame to the switch unit with screws, and attach the faceplate cover to the frame.

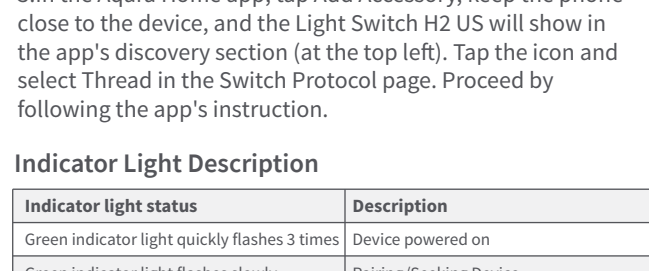

4. Turn on the power at the circuit breaker and test the switch by pressing the upper button. If the wired light can be controlled by the upper button, the switch is functioning correctly.

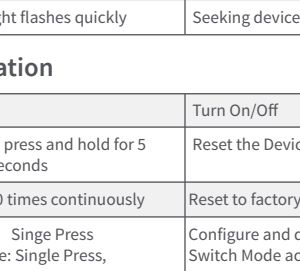

5. In the Aqara Home app, tap Add Accessory, choose Light Switch H2 US. Scan the Matter QR Code on the paper manual to add the device to the app. The following Quick Setup section will introduce the network configuration methods for both Zigbee and Thread protocols.

\* If the QR code on the paper manual is lost, you can open the product cover and scan the QR code on the metal frame of the product.

## Quick Setup

To use the device with a particular Matter ecosystem (Thread Mode), a Matter Controller of this ecosystem and a Thread Border Router are required.

1. Double-press any button, then press and hold it for 5 seconds until the green indicator light starts blinking. This indicates that the device is in pairing mode.
2. Open the app that supports Matter, scan the Matter code on the manual or product, or enter the setup code to add the device to the app.
3. Proceed following the app's instruction.

To use the device in Aqara Home (Thread Mode), an Aqara Hub with border router function (for example, Hub M3) is required:

1. Double-press any button, then press and hold it for 5 seconds until the green indicator light starts blinking. This indicates that the device is in pairing mode.
2. In the Aqara Home app, tap Add Accessory, choose Light Switch H2 US. Scan the Matter code on the manual or product or enter the setup code to add the device to the app. Select Thread on the Switch Protocol page.
3. Proceed by following the app's instruction.

To use the device in Aqara Home (Zigbee Mode), an Aqara Zigbee Hub is required:

1. Double-press any button, then press and hold it for 5 seconds until the green indicator light starts blinking. This indicates that the device is in pairing mode.
2. In the Aqara Home app, tap Add Accessory, keep your phone close to the device, and Light Switch H2 US will appear in the app's discovery section (at the top left). Tap the icon and select Zigbee on the Switch Protocol page.
3. Proceed by following the app's instruction.

## Regarding Dual Protocol (Thread/Zigbee) Switching

Q: How to switch from Thread protocol to Zigbee protocol?

A:

1. Install the Aqara Home app, and enable Wi-Fi and Bluetooth.
2. Reset the device to factory settings (press any button 10 times continuously) to enter network setup (the first time you add the device it will automatically begin pairing), with its green indicator light flashing quickly.
3. In the Aqara Home app, tap Add Accessory, scan the Matter code on the manual or product, then select Zigbee on the Switch Protocol page. Proceed by following the app's instruction.

Q: How to switch from Zigbee protocol to Thread protocol?

A:

1. Install the Aqara Home app, and enable Wi-Fi and Bluetooth.
2. Reset the device to factory settings (press any button 10 times continuously), then enter network setup (yellow indicator light flashes quickly).
3. In the Aqara Home app, tap Add Accessory, keep the phone close to the device, and the Light Switch H2 US will show in the app's discovery section (at the top left). Tap the icon and select Thread in the Switch Protocol page. Proceed by following the app's instruction.

## Indicator Light Description

Indicator light status	Description
Green indicator light quickly flashes 3 times	Device powered on
Green indicator light flashes slowly	Pairing/Seeking Device
Green indicator light flashes quickly	Pairing/Seeking Device (Thread protocol)
Green indicator light stays on for 1s	Pairing successful
Red indicator light stays on	Device offline
Red indicator light flashes slowly 3 times	Device voltage is unstable, please connect to a higher power load
Yellow indicator light flashes quickly	Seeking device (Zigbee protocol)

## Button Operation

Single press	Turn On/Off
Double press, then press and hold for 5 seconds within 3 seconds	Reset the Device/Enable Pairing
Press any button 10 times continuously	Reset to factory settings
Single-Press Mode: Single Press, Double Press, Long Press	Configure and define these Wireless Switch Mode actions under Automation in Aqara Home (Zigbee Mode)

## Product Specifications

Product Name	Light Switch H2 US (2 Buttons, 1 Channel)	Light Switch H2 US (2 Buttons, 2 Channels)	Light Switch H2 US (4 Buttons, 3 Channels)
Model	WS-K02E	WS-K03E	WS-K04E
Wireless Protocols	Thread, Zigbee, Bluetooth		
Dimensions	119 × 74 × 42mm		
Electrical Rating	120 VAC, 60 Hz, Max 10 A (Resistive Load or Incandescent), μ		
Minimum Power	5 W (No Neutral), Unlimited (With Neutral), general purpose		
Thread Operation Frequency	2400-2483.5Mhz		
Thread Maximum Output Power	≤ 13 dBm		
Bluetooth Operation Frequency	2400-2483.5Mhz		
Bluetooth Maximum Output Power	≤ 13 dBm		
Operating Temperature	0°C ~ 40°C (32°F ~ 104°F)		
Operating Humidity	0 ~ 95% RH, no condensation		
What is in the Box	Light Switch H2 US × 1, Compliance Statement × 1, User Manual × 1, Screw Kit × 1, Wire Nuts Kit × 1, Wiring Sticker Sheet × 1		



## **Light Switch H2 Vertical – User Manual**

For

Light Switch H2 Vertical (2 Buttons, 1 Channel)

Light Switch H2 Vertical (2 Buttons, 2 Channels)

Light Switch H2 Vertical (4 Buttons, 3 Channels)

EN	Light Switch H2 Vertical User Manual
KR	조명 스위치 H2 – 사용 설명서

Product Introduction

Aqara Light Switch H2 Vertical is a smart switch based on Thread/Zigbee wireless communication protocols which can control lights, automations, and scenes. When used with a hub, it can be controlled via the app, and has features for scheduling, power monitoring, power statistics, and other functions. It can also be used with other smart devices to enable a variety of interconnected control functions.

\*This product needs to be used with a device that has Matter Border Router function.

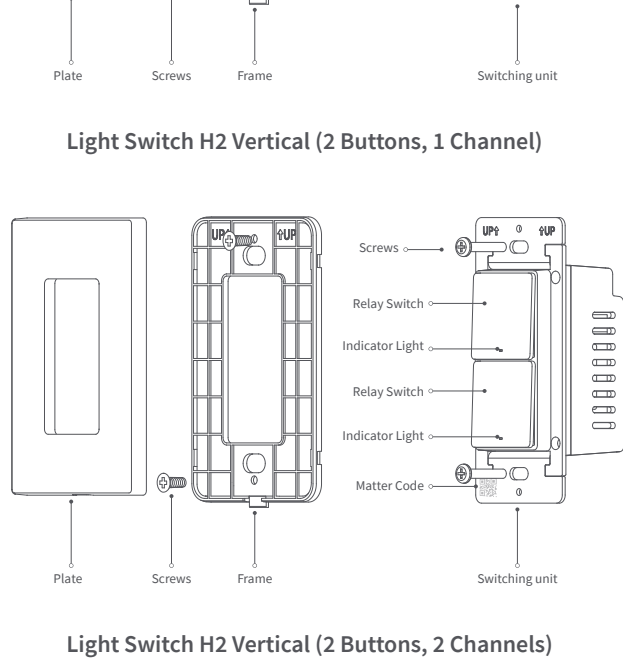

Light Switch H2 Vertical (2 Buttons, 1 Channel)

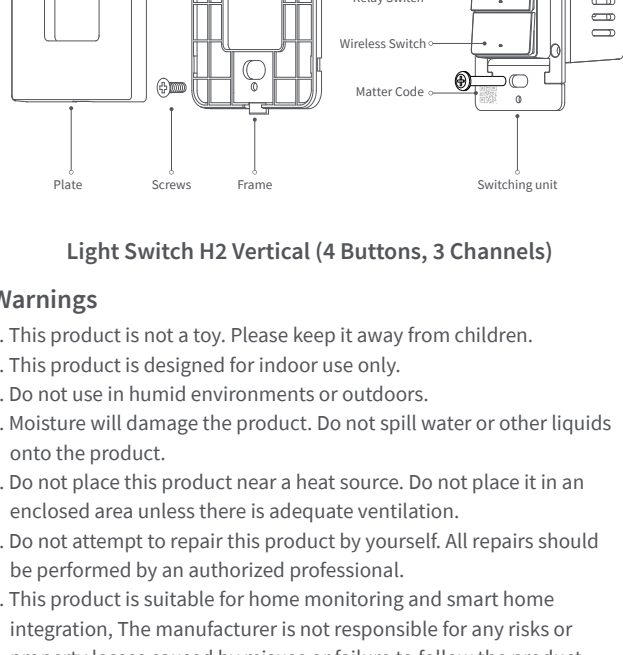

Light Switch H2 Vertical (2 Buttons, 2 Channels)

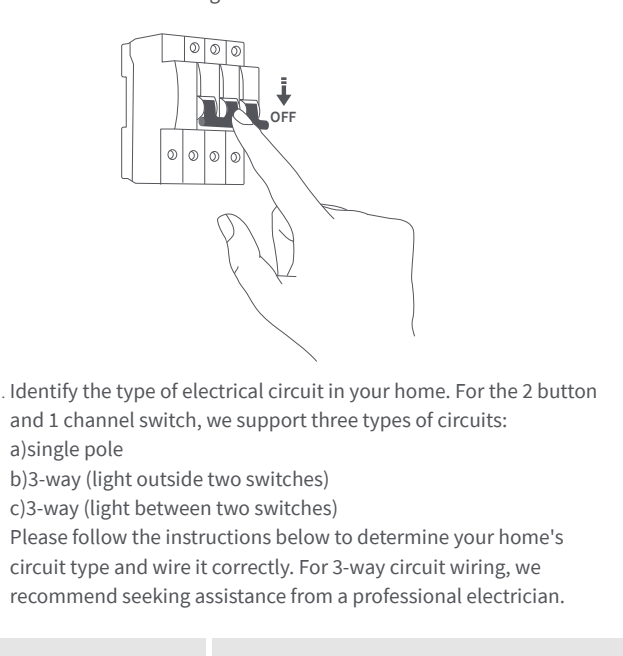

Light Switch H2 Vertical (4 Buttons, 3 Channels)

Warnings

- 1. This product is not a toy. Please keep it away from children.
- 2. This product is designed for indoor use only.
- 3. Do not use in humid environments or outdoors.
- 4. Moisture will damage the product. Do not spill water or other liquids onto the product.
- 5. Do not place this product near a heat source. Do not place it in an enclosed area unless there is adequate ventilation.
- 6. Do not attempt to repair this product by yourself. All repairs should be performed by an authorized professional.
- 7. This product is suitable for home monitoring and smart home integration, The manufacturer is not responsible for any risks or property losses caused by misuse or failure to follow the product instructions.

Installation Method

Light Switch H2 Vertical (2 Buttons, 1 Channel)

- 1. Please make sure that the power at circuit breaker or fuse box is turned off before wiring!

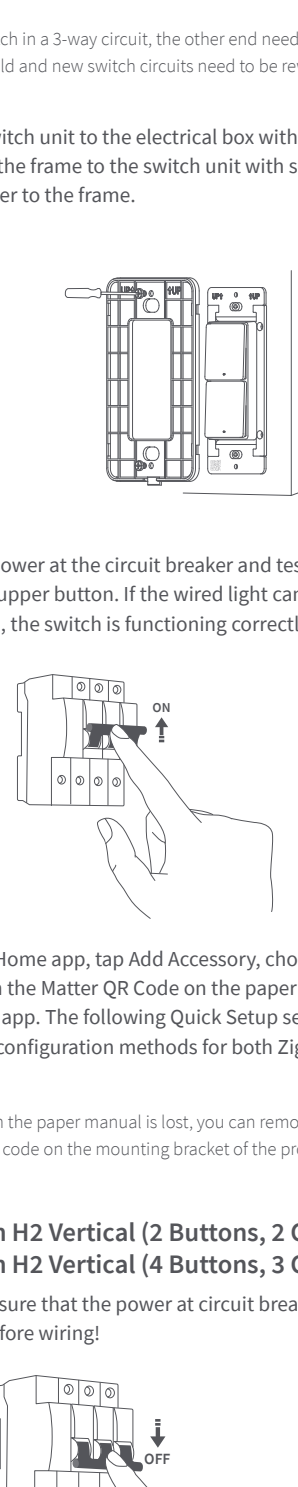

- 2. Identify the type of electrical circuit in your home. For the 2 button and 1 channel switch, we support three types of circuits:
  - a)single pole
  - b)3-way (light outside two switches)
  - c)3-way (light between two switches)Please follow the instructions below to determine your home's circuit type and wire it correctly. For 3-way circuit wiring, we recommend seeking assistance from a professional electrician.

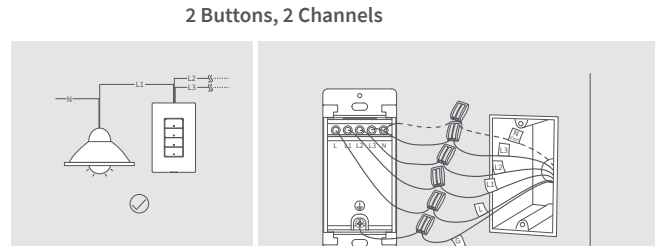

Single Pole Wiring

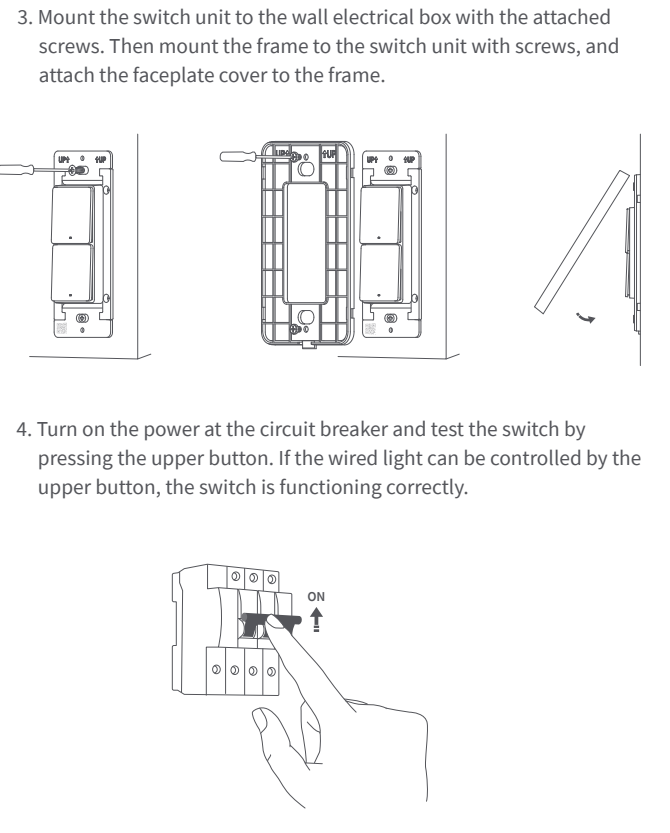

3-Way (Light Outside Two Switches)

\* Use only one switch in a 3-way circuit, the other end needs to be a normal standard switch. Both the old and new switch circuits need to be rewired according to the diagram.

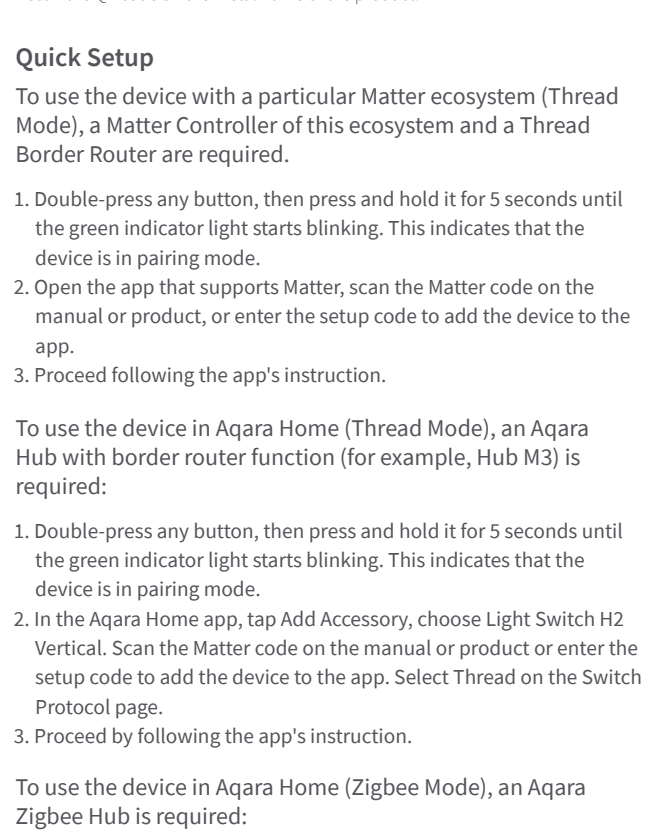

3-Way (Light Between Two Switches)

\* Use only one switch in a 3-way circuit, the other end needs to be a normal standard switch. Both the old and new switch circuits need to be rewired according to the diagram.

- 3. Mount the switch unit to the electrical box with the attached screws. Then mount the frame to the switch unit with screws, and attach the faceplate cover to the frame.



- 4. Turn on the power at the circuit breaker and test the switch by pressing the upper button. If the wired light can be controlled by the upper button, the switch is functioning correctly.

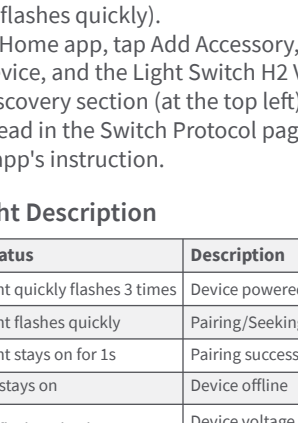

- 5. In the Aqara Home app, tap Add Accessory, choose Light Switch H2 Vertical. Scan the Matter QR Code on the paper manual to add the device to the app. The following Quick Setup section will introduce the network configuration methods for both Zigbee and Thread protocols.

\*If the QR code on the paper manual is lost, you can remove the plastic cover frame and scan the QR code on the mounting bracket of the product.

Light Switch H2 Vertical (2 Buttons, 2 Channels)

Light Switch H2 Vertical (4 Buttons, 3 Channels)

- 1. Please make sure that the power at circuit breaker or fuse box is turned off before wiring!

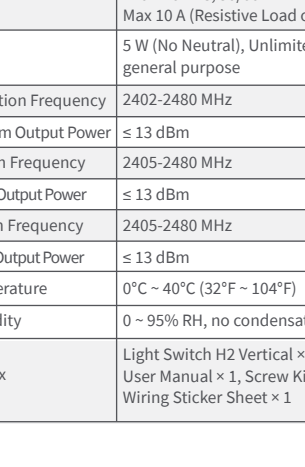

- 2. For users with Light Switch H2 Vertical (2 Buttons, 2 Channels) or (4 Buttons, 3 Channels), please follow the corresponding wiring methods according to your product model. It is recommended to seek assistance from a professional electrician to complete this step.



2 Buttons, 2 Channels



4 Buttons, 3 Channels

- 3. Mount the switch unit to the wall electrical box with the attached screws. Then mount the frame to the switch unit with screws, and attach the faceplate cover to the frame.



- 4. Turn on the power at the circuit breaker and test the switch by pressing the upper button. If the wired light can be controlled by the upper button, the switch is functioning correctly.



- 5. In the Aqara Home app, tap Add Accessory, choose Light Switch H2 Vertical. Scan the Matter QR Code on the paper manual to add the device to the app. The following Quick Setup section will introduce the network configuration methods for both Zigbee and Thread protocols.

\*If the QR code on the paper manual is lost, you can open the product cover and scan the QR code on the metal frame of the product.

Quick Setup

To use the device with a particular Matter ecosystem (Thread Mode), a Matter Controller of this ecosystem and a Thread Border Router are required.

- 1. Double-press any button, then press and hold it for 5 seconds until the green indicator light starts blinking. This indicates that the device is in pairing mode.
- 2. Open the app that supports Matter, scan the Matter code on the manual or product, or enter the setup code to add the device to the app.
- 3. Proceed following the app's instruction.

To use the device in Aqara Home (Thread Mode), an Aqara Hub with border router function (for example, Hub M3) is required:

- 1. Double-press any button, then press and hold it for 5 seconds until the green indicator light starts blinking. This indicates that the device is in pairing mode.
- 2. In the Aqara Home app, tap Add Accessory, choose Light Switch H2 Vertical. Scan the Matter code on the manual or product or enter the setup code to add the device to the app. Select Thread on the Switch Protocol page.
- 3. Proceed by following the app's instruction.

To use the device in Aqara Home (Zigbee Mode), an Aqara Zigbee Hub is required:

- 1. Double-press any button, then press and hold it for 5 seconds until the green indicator light starts blinking. This indicates that the device is in pairing mode.
- 2. In the Aqara Home app, tap Add Accessory, keep your phone close to the device, and the Light Switch H2 Vertical will appear in the app's discovery section (at the top left). Tap the icon and select Zigbee on the Switch Protocol page.
- 3. Proceed by following the app's instruction.

Regarding Dual Protocol (Thread/Zigbee) Switching

Q: How to switch from Thread protocol to Zigbee protocol?

A:

- 1.Install the Aqara Home app, and enable Wi-Fi and Bluetooth.
- 2.Reset the device to factory settings (press any button 10 times continuously) to enter network setup (the first time you add the device it will automatically begin pairing), with its green indicator light flashing quickly.
- 3.In the Aqara Home app, tap Add Accessory, scan the Matter code on the manual or product, then select Zigbee on the Switch Protocol page. Proceed by following the app's instruction.

Q: How to switch from Zigbee protocol to Thread protocol?

A:

- 1.Install the Aqara Home app, and enable Wi-Fi and Bluetooth.
- 2.Reset the device to factory settings (press any button 10 times continuously), then enter network setup (yellow indicator light flashes quickly).
- 3.In the Aqara Home app, tap Add Accessory, keep the phone close to the device, and the Light Switch H2 Vertical will show in the app's discovery section (at the top left). Tap the icon and select Thread in the Switch Protocol page. Proceed by following the app's instruction.

Indicator Light Description

Indicator light status	Description
Green indicator light quickly flashes 3 times	Device powered on
Green indicator light flashes quickly	Pairing/Seeking Device (Thread protocol)
Green indicator light stays on for 1s	Pairing successful
Red indicator light stays on	Device offline
Red indicator light flashes slowly 3 times	Device voltage is unstable, please connect to a higher power load
Yellow indicator light flashes quickly	Seeking device (Zigbee protocol)

Button Operation

Single press	Turn On/Off
Double press, then press and hold for 5 seconds within 3 seconds	Reset the Device/Enable Pairing
Press any button 10 times continuously	Reset to factory settings
Single-Press Mode: Single Press Multi-function Mode: Single Press, Double Press, Long Press	Configure and define these Wireless Switch Mode actions under Automation in Aqara Home (Zigbee Mode)

Product Specifications

Product Name	Light Switch H2 Vertical (2 Buttons, 1 Channel)	Light Switch H2 Vertical (2 Buttons, 2 Channels)	Light Switch H2 Vertical (4 Buttons, 3 Channels)
Model	WS-K02E	WS-K03E	WS-K04E
Wireless Protocols	Thread, Zigbee, Bluetooth		
Dimensions	119 × 74 × 42mm		
Electrical Rating	120-240 VAC, 50/60 Hz Max 10 A (Resistive Load or Incandescent), μ		
Minimum Power	5 W (No Neutral), Unlimited (With Neutral), general purpose		
Bluetooth Operation Frequency	2402-2480 MHz		
Bluetooth Maximum Output Power	≤ 13 dBm		
Thread Operation Frequency	2405-2480 MHz		
Thread Maximum Output Power	≤ 13 dBm		
Zigbee Operation Frequency	2405-2480 MHz		
Zigbee Maximum Output Power	≤ 13 dBm		
Operating Temperature	0°C ~ 40°C (32°F ~ 104°F)		
Operating Humidity	0 ~ 95% RH, no condensation		
What is in the Box	Light Switch H2 Vertical × 1, Compliance Statement × 1, User Manual × 1, Screw Kit × 1, Wire Connectors Kit × 1, Wiring Sticker Sheet × 1		



## **Light Switch H2 Vertical – User Manual**

For

Light Switch H2 Vertical (2 Buttons, 1 Channel)

Light Switch H2 Vertical (2 Buttons, 2 Channels)

Light Switch H2 Vertical (4 Buttons, 3 Channels)

EN	Light Switch H2 Vertical User Manual
KR	조명 스위치 H2 – 사용 설명서



## 제품 소개

조명 스위치 H2는 조명을 스마트하게 제어 할 수 있게하는 Thread/Zigbee 무선 통신 프로토콜 스마트 스위치입니다. 허브와 함께 사용하여 앱을 통한 원격 제어, 일정 예약, 전원 모니터링 등의 기능을 사용할 수 있습니다. 또한 다른 스마트 장치와 연동을 통해 다양한 시나리오를 구성할 수 있습니다.

\*본 제품을 지원하는 아카라 Zigbee 허브 또는 Matter Border Router와 함께 사용해야 합니다.

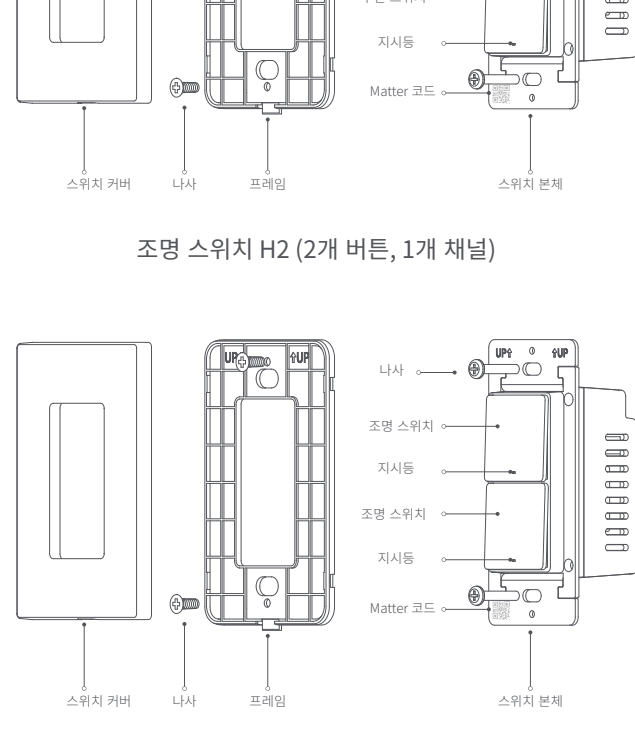

조명 스위치 H2 (2개 버튼, 1개 채널)

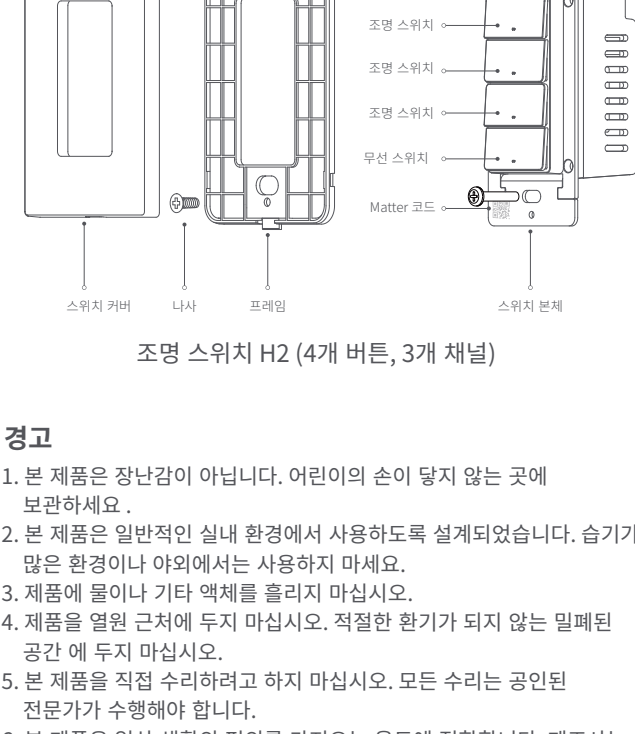

조명 스위치 H2 (2개 버튼, 2개 채널)

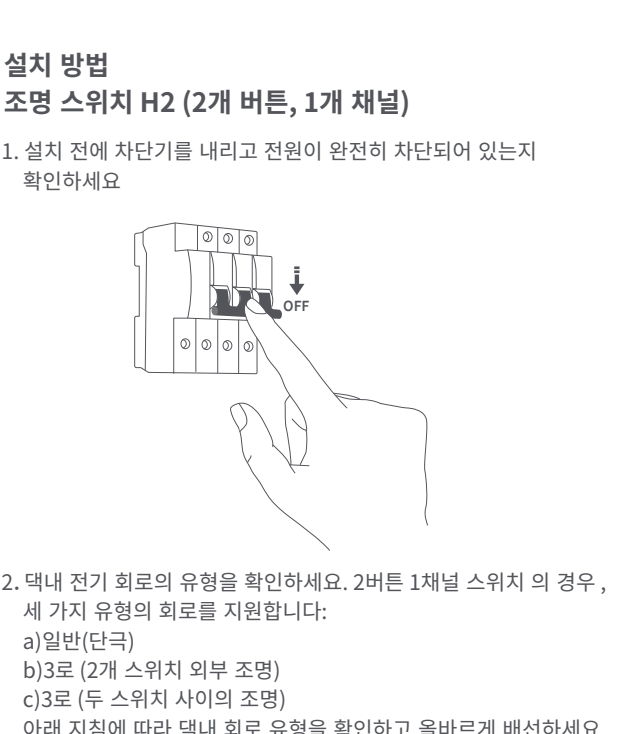

조명 스위치 H2 (4개 버튼, 3개 채널)

## 경고

1. 본 제품은 장난감이 아닙니다. 어린이의 손이 닿지 않는 곳에 보관하세요 .
2. 본 제품은 일반적인 실내 환경에서 사용하도록 설계되었습니다. 습기가 많은 환경이나 야외에서는 사용하지 마세요.
3. 제품에 물이나 기타 액체를 흘리지 마십시오.
4. 제품을 열원 근처에 두지 마십시오. 적절한 환기가 되지 않는 밀폐된 공간 에 두지 마십시오.
5. 본 제품을 직접 수리하려고 하지 마십시오. 모든 수리는 공인된 전문가가 수행해야 합니다.
6. 본 제품은 일상 생활의 편의를 가져오는 용도에 적합합니다. 제조사는 제품 지침을 따르지 않거나 오용으로 인해 발생하는 위험이나 재산 손실에 대해 책임을 지지 않습니다.

## 설치 방법

### 조명 스위치 H2 (2개 버튼, 1개 채널)

1. 설치 전에 차단기를 내리고 전원이 완전히 차단되어 있는지 확인하세요

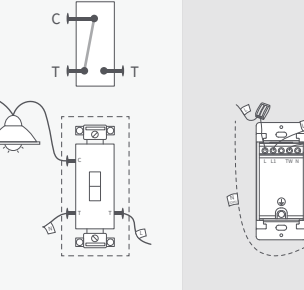

2. 맥내 전기 회로의 유형을 확인하세요. 2버튼 1채널 스위치 의 경우 , 세 가지 유형의 회로를 지원합니다:

a)일반(단극)

b)3로 (2개 스위치 외부 조명)

c)3로 (두 스위치 사이의 조명)

아래 지침에 따라 맥내 회로 유형을 확인하고 올바르게 배선하세요.

3로 배선의 경우 전문 전기 기술자의 도움을 받는 것이 좋습니다.

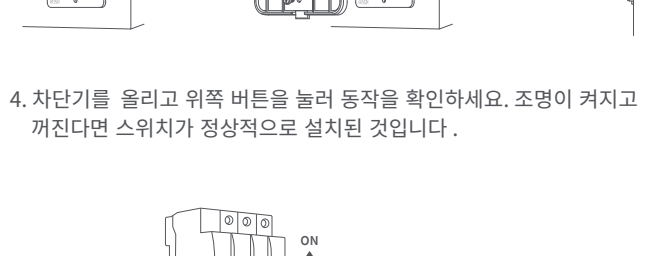

일반(단극) 배선

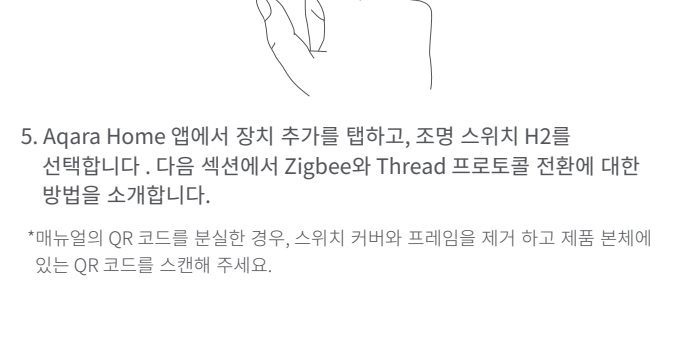

3로 (두 스위치와 외부 조명) 배선

\* 3로 회로에서는 조명 스위치 H2를 하나만 사용하고, 다른 쪽은 일반 3로 스위치여야 합니다. 기존 스위치 회로와 새로운 스위치 회로 모두 다이어그램에 따라 다시 배선 해야 합니다 .

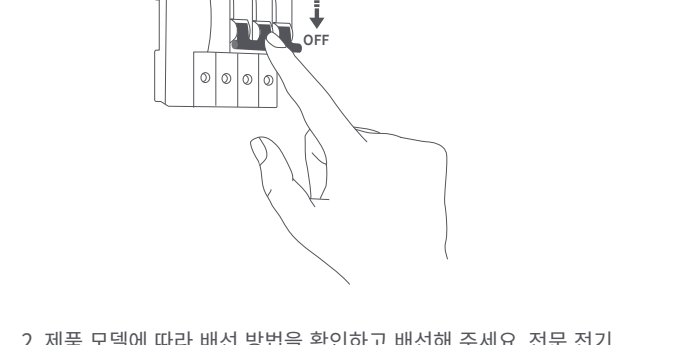

3로 (두 스위치 사이의 조명) 배선

\* 3로 회로에서는 조명 스위치 H2를 하나만 사용하고, 다른 쪽은 일반 3로 스위치여야 합니다. 기존 스위치 회로와 새로운 스위치 회로 모두 다이어그램에 따라 다시 배선 해야 합니다 .

3. 동봉된 나사를 이용하여 스위치 본체를 스위치 박스에 결합합니다. 그런 다음 나사를 사용하여 프레임이 스위치 본체와 결합하고, 커버를 프레임과 결합합니다.



4. 차단기를 올리고 위쪽 버튼을 눌러 동작을 확인하세요. 조명이 켜지고 꺼진다면 스위치가 정상적으로 설치된 것입니다 .

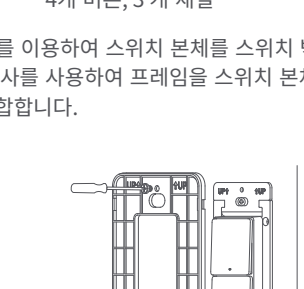

5. Aqara Home 앱에서 장치 추가를 탭하고, 조명 스위치 H2를 선택합니다 . 다음 섹션에서 Zigbee와 Thread 프로토콜 전환에 대한 방법을 소개합니다.

\*매뉴얼의 QR 코드를 분실한 경우, 스위치 커버와 프레임의 제거 하고 제품 본체에 있는 QR 코드를 스캔해 주세요.

### 조명 스위치 H2 (2개 버튼, 2개 채널)

### 전등 스위치 H2 (4개 버튼, 3개 채널)

1. 설치 전에 차단기를 내리고 전원이 완전히 차단되어 있는지 확인하세요.

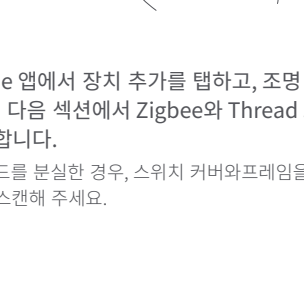

2. 제품 모델에 따라 배선 방법을 확인하고 배선에 주세요. 전문 전기 기술자의 도움을 받는 것이 좋습니다.

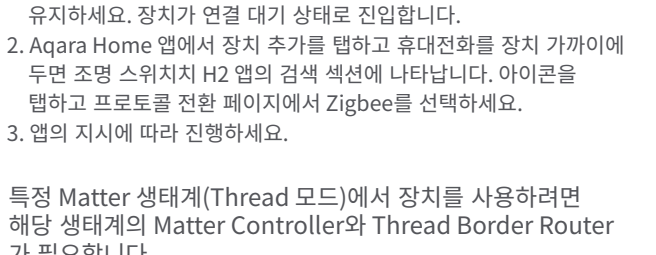

2개 버튼, 2 개 채널

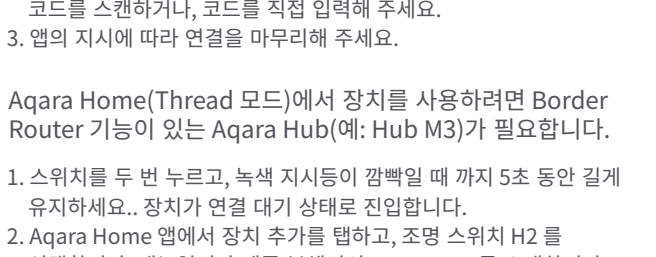

4개 버튼, 3 개 채널

3. 동봉된 나사를 이용하여 스위치 본체를 스위치 박스에 결합합니다. 그런 다음 나사를 사용하여 프레임이 스위치 본체와 결합하고, 커버를 프레임과 결합합니다.

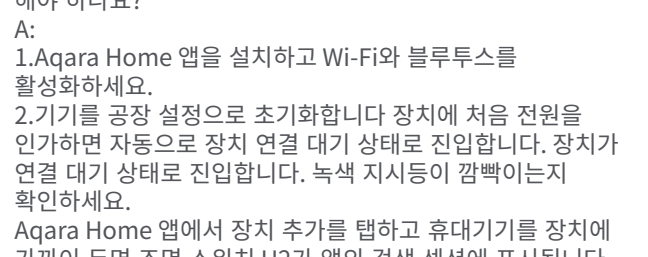

4. 차단기를 올리고 위쪽 버튼을 눌러 동작을 확인하세요. 조명이 켜지고 꺼진다면면 스위치가 정상적으로 설치된 것입니다 .

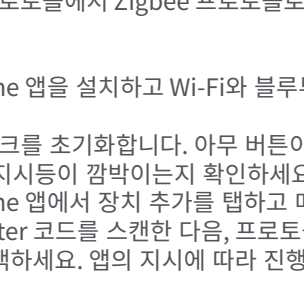

5. Aqara Home 앱에서 장치 추가를 탭하고, 조명 스위치 H2를 선택합니다 . 다음 섹션에서 Zigbee와 Thread 프로토콜 전환에 대한 방법을 소개합니다.

\*매뉴얼의 QR코드를 분실한 경우, 스위치 커버와프레임을 제거하고 제품 본체에 있는QR코드를 스캔해 주세요.

## 빠른 설정

Aqara Home(Zigbee 모드)에서 장치를 사용하려면 Aqara Zigbee Hub가 필요합니다.

1. 스위치를 두 번 누르고, 녹색 지시등이 깜빡일 때 까지 5초 동안 길게 유지하세요. 장치가 연결 대기 상태로 진입합니다.

2. Aqara Home 앱에서 장치 추가를 탭하고 휴대전화를 장치 가까이에 두면 조명 스위치 H2 앱의 검색 섹션에 나타납니다. 아이콘을 탭하고 프로토콜 전환 페이지에서 Zigbee를 선택하세요.

3. 앱의 지시에 따라 진행하세요.

특정 Matter 생태계(Thread 모드)에서 장치를 사용하려면 해당 생태계의 Thread Controller와 Thread Border Router 가 필요합니다.

1. 스위치를 두 번 누르고 녹색 지시등이 깜빡일 때 까지 5초 동안 길게 유지하세요. 장치가 연결 대기 상태로 진입합니다.

2. Matter를 지원하는 앱을 열고 매뉴얼 또는 제품 본체의 Matter 코드를 스캔하거나, 코드를 직접 입력해 주세요.

3. 앱의 지시에 따라 연결을 마무리해 주세요.

Aqara Home(Thread 모드)에서 장치를 사용하려면 Border Router 기능이 있는 Aqara Hub(예: Hub M3)가 필요합니다.

1. 스위치를 두 번 누르고, 녹색 지시등이 깜빡일 때 까지 5초 동안 길게 유지하세요.. 장치가 연결 대기 상태로 진입합니다.

2. Aqara Home 앱에서 장치 추가를 탭하고, 조명 스위치 H2 를 선택합니다. 매뉴얼이나 제품 본체의 Matter 코드를 스캔하거나 코드를 직접 입력해 주세요. 현재 프로토콜이 Thread 연결이 맞는지 앱에서 확인하세요.

3. 앱의 지시에 따라 연결을 마무리해 주세요.

듀얼 프로토콜(Thread/Zigbee) 전환에 관하여

Q: Zigbee 프로토콜에서 Thread 프로토콜로 전환하려면 어떻게 해야 하나요?

A:

- 1.Aqara Home 앱을 설치하고 Wi-Fi와 블루투스를 활성화하세요.

- 2.기기를 공장 설정으로 초기화합니다 장치에 처음 전원을 인가하면 자동으로 장치 연결 대기 상태로 진입합니다. 장치가 연결 대기 상태로 진입합니다. 녹색 지시등이 깜빡이는지 확인하세요.

Aqara Home 앱에서 장치 추가를 탭하고 휴대기기를 장치에 가까이 두면 조명 스위치 H2가 앱의 검색 섹션에 표시됩니다.

아이콘을 탭하고 스위치 전환 페이지에서 Thread를 선택하세요. 앱의 지시에 따라 진행하세요.

Q: Thread 프로토콜에서 Zigbee 프로토콜로 전환하는 방법은 무엇인가요?

A:

- 1.Aqara Home 앱을 설치하고 Wi-Fi와 블루투스를 활성화하세요.

- 2.장치 네트워크를 초기화합니다. 아무 버튼이나 10회 연속 누르기. 녹색 지시등이 깜빡이는지 확인하세요.

- 3.Aqara Home 앱에서 장치 추가를 탭하고 매뉴얼 또는 제품 본체에서 Matter 코드를 스캔한 다음, 프로토콜 전환 페이지에서 Zigbee를 선택하세요. 앱의 지시에 따라 진행하세요.

## 지시등 설명

지시등 상태	설명
녹색 빠르게 3번 깜빡임	장치 전원 켜짐
녹색 빠르게 깜빡임	장치 찾기(Thread 프로토콜)
녹색 1초 동안 켜짐	연결 성공
빨간색 지속 점등	장치 오프라인
빨간색 느리게 3번 깜빡임	전력 공급 불안정(더 큰 부하에 연결 필요)
노란색 빠르게 깜빡임	장치 찾기(Zigbee 프로토콜)

## 버튼 설명

1회 누르기	켜기/끄기
2회 누르고 5초간 길게 유지	장치 재설정/ 연결 모드 진입
아무 버튼이나 10회 누르기	공장 초기화
하이 스피드 모드: 한 번 누름 다기능 모드: 한 번 누름, 두 번 누름, 길게 누름	Aqara Home(Zigbee 모드)의 장치 설정에서 무선 스위치의 동작 모드 설정 가능

## 제품 사양

제품 이름	조명 스위치 H2 (2버튼, 1채널)	조명 스위치 H2 (2버튼, 2채널)	조명 스위치 H2 (4버튼, 3채널)
모델	WS-K02E	WS-K03E	WS-K04E
무선 프로토콜	Thread , Zigbee , Bluetooth		
제품 크기	119 × 74 × 42mm		
전기 정격	120-240 VAC, 50/60 Hz 최대 10A(저항성 부하 또는 백열전구)		
최소 전력	5W(중성선을 연결하지 않은 경우), 없음(중성선을 연결한 경우)		
Bluetooth 작동 주파수	2402-2480 MHz		
Bluetooth 최대 출력 전력	≤ 13 dBm		
Thread 작동 주파수	2405-2480 MHz		
Thread 최대 출력 전력	≤ 13 dBm		
Zigbee 작동 주파수	2405-2480 MHz		
Zigbee 최대 출력 전력	≤ 13 dBm		
작동 온도	0°C ~ 40°C (32°F ~ 104°F)		
작동 습도	0 ~ 95% RH, 비결로 조건		
제품 구성	조명 스위치 H2 × 1, 규정 준수 설명서 × 1, 사용 설명서 × 1, 나사 키트 × 1, 와이어 커넥터 키트 × 1, 배선 스티커 시트 × 1		